

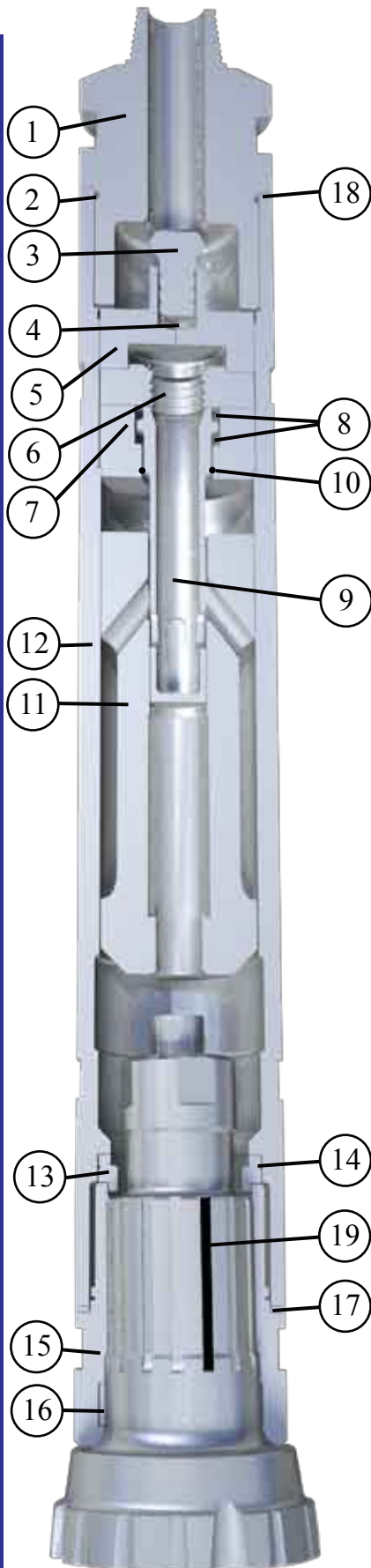

**Bulroc Hyper 141
D.T.H Hammer**



Hyper 141 Valveless Hammer

350mm (13¾") - 508mm (20") diameter holes

The Bulroc Hyper 141 hammer is a valveless D.T.H Hammer designed to operate over a wide range of operating pressures. The Hyper 141 is supplied with a 6 5/8 " API regular pin backhead as standard.

The Hyper 141 is fitted with a positive seating Water Check Valve and is supplied as standard, fitted with a Solid Choke.

The Hyper 141 is primarily designed to be used with the Numa 125, but other shanks will be considered on request.

Component Parts

Ref	Description	Part Number
1	Backhead 6 5/8" Reg. Pin	HSH1413880M
2	Backhead 'O' Ring	HSH12114
3	Check Valve	HSH12108
4	Check Valve Spring	HSH12110
5	Diverter	HSH14120
6	Compression Buffer	HSH14128
7	Control Tube Holder	HSH14131
8	Control Tube Buffers (2)	HSH14129
9	Control Tube	HSH14130
10	Control Tube 'O' Ring	HSH14130A
11	Piston	HSH14103125
12	Wearsleeve	HSH14100
13	Bit Retainer (pair)	HSH14137125
14	Bit Retainer 'O' Ring	HSH14137AST
15	Chuck (N125 C/W drive plate slot)	HSH14135125
16	Chuck Bearing	HSH14135125BE
17	Breakout Washer (Chuck)	HSH14126
18	Breakout Washer (Backhead)	HSH14125
19	Drive Plate N125 (10)	DP125
	Complete Hammer	BR141H01

Hammer Specification

	Imperial	Metric
Weight (less bit)	2420 lbs	1100 Kgs
Length (less bit)	68.9"	1750 mm
Outside dia.	12.6"	320 mm
Piston weight	275 lbs	125 Kgs
Stroke	5.00"	127 mm

Air Consumption

PSI	BAR	C.F.M	Cu. Mtr / min
100	10.3	478	13.5
150	13.8	879	24.0
200	17.2	1354	38.3
250	20.7	1742	49.3



Bulroc (UK) Ltd.

Station Lane, Old Whittington, Chesterfield,
Derbyshire, United Kingdom. S41 9QX

Tel : +44(0)1246 450608 Fax : +44(0)1246 454621

Email : info@bulroc.com Web: www.bulroc.com