

Bullroc
[U.K.] LTD



Hyper 66 / DHD 360
Deep Hole Hammer

Hyper 66DH / DHD 360 (Deep Hole) Hammer

152mm (6") - 216mm (8") dia. Holes

TECHNICAL SPECIFICATIONS

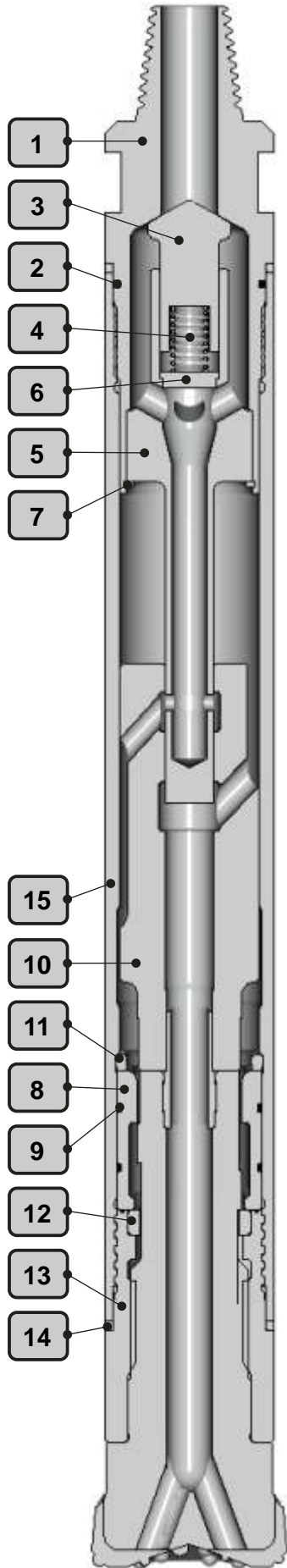

The Hyper 66DH is a valveless DTH Hammer specifically designed to operate efficiently at depths and overcome high heads of water. The combined control tube, diverter and check valve minimises the number of component parts, reducing the overall length of the Hammer for ease of handling.

The Hyper 66DH is supplied as standard with a 3 1/2" API reg. pin backhead and a chuck to accept button bits with Ingersoll Rand DHD360 shanks.

Alternatively, the Hyper 66DH can also be supplied with chuck's to suit most other major types of button bits including IR QI60.

COMPONENT PARTS

Ref	Description	Part Number	Qty
1	Backhead	HSW663803M	1
2	Backhead 'O' ring	HSH6114	1
3	Check valve	IPRCV04	1
4	Check valve spring	IPRCVS04	1
5	Diverter	HSW6630	1
6	Diverter plug	HSW6630PLUG	1
7	Circlip	HSW6622	1
8	Bush	HSW6686	1
9	Bush 'O' ring	HSH6386A	1
10	Piston	HSW6603	1
11	Piston retaining ring	HSH6132	1
12	Bit retaining ring	HSW6637093	1
13	Chuck	HSW6635093	1
14	Breakout washer	HSH66326	2
15	Wearsleeve	HSW6600	1
	Complete hammer	BR66DH01	

HAMMER SPECIFICATION

	English	Metric
Weight (less bit)	219lbs	100kgs
Length (less bit)	44.625"	1133mm
Outside diameter	5.620"	142.75mm
Piston weight	43.5lbs	20kgs
Stroke	4.25"	108mm

AIR CONSUMPTION

PSI	BAR	C.F.M.	Cu.Mtr/min
150	10.3	296	8.39
200	13.8	456	12.92
250	17.2	637	18.05
300	20.7	838	23.73