

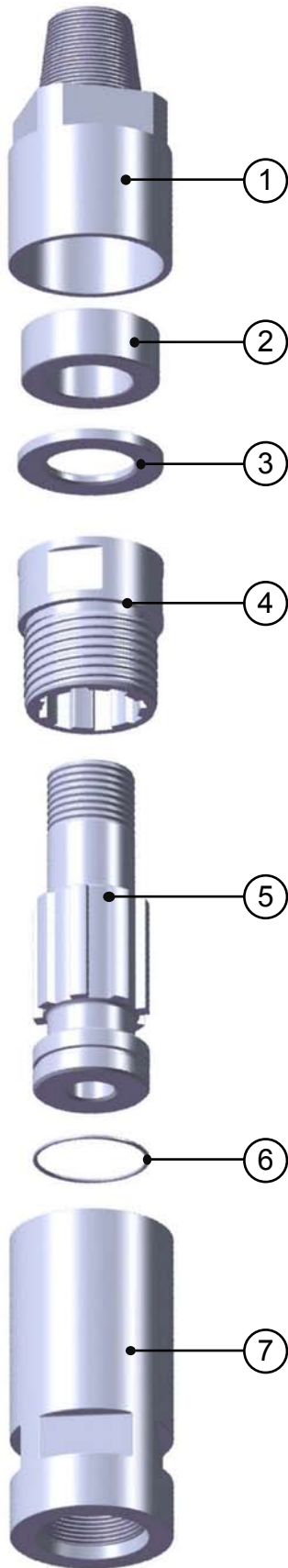

**Bulrooc HD Series 8"-10"
Shock Absorbers**

Bulroc HD Series Shock Absorbers for use with larger hammers



Maintenance Instructions for 8" & 10" Shock Absorbers

The Bulroc HD range of Shock Absorbers should be dismantled and the components inspected every 500 hours of operation or every 6 months of intermittent operation.

First unscrew the Top Connector from the Bottom Connector by locking the Bottom Connector with a suitable spanner against a solid base and split the Top Connector at the spanner flats. Remove and inspect the Buffer. If this is showing any signs of wear or fatigue, it must be replaced. Now unscrew the Splined Nut from the Bottom Connector and remove the Shaft. Inspect the 'O' Ring and replace if necessary.

Important

It is inevitable that there will be progressive wear between the Bottom Connector shaft and the Nut. When this wear pattern exceeds 2mm in either component, it is recommended that this component be replaced since excessive wear will eventually lead to failure of the Bottom Connector shaft or thread with consequent loss of hammer and bit. Clean all the components and then coat the splines on both the Shaft and the Nut with good quality grease. Now, lower the Nut and shaft into the Bottom connector and tighten the Nut down. Then put the Thrust Washer over the Shaft so it sits on the Nut face, slide the Buffer down the Shaft up to the Washer face. Grease the internal top connector thread and screw down onto the Shaft. Using suitable spanners, torque up fully.

Size	HDSA8 4½" API	HDSA10 6 5/8" API
Effective Length	591 mm / 23.27"	635 mm / 25.00"
Outside Diameter	178 mm / 7.01"	216 mm / 8.50"
Net Weight	84 Kg / 184.8 lbs	98 Kg / 215.6 lbs

Components		HDSA8 4½" API	HDSA10 6 5/8" API
1	Top Connector	SA08ST0880M	SA10ST0880M
2	Buffer	SA08ST05	SA10ST05
3	Thrust Washer	SA08ST04	SA10ST04
4	Nut	SA08ST01	SA10ST01
5	Shaft	SA08ST02	SA10ST02
6	Shaft 'O' Ring	SA08ST03	SA10ST03
7	Bottom Connector	SA08ST0980F	SA10ST0980F
	Complete Shock Absorber	SA08ST080MF	SA10ST080MF