

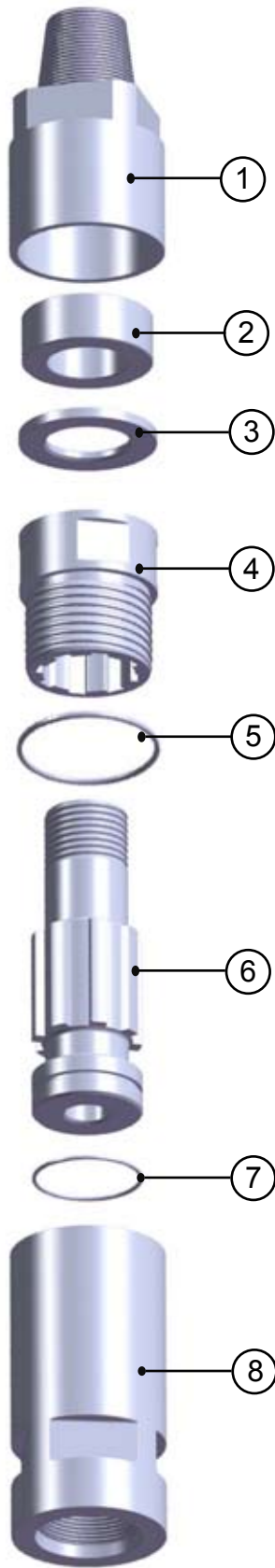

Bulroc HD Series 12"-14" Shock Absorbers

Bulroc HD Series Shock Absorbers for use with larger hammers



Maintenance Instructions for 12" & 14" Shock Absorbers

The Bulroc HD range of Shock Absorbers should be dismantled and the components inspected every 500 hours of operation or every 6 months of intermittent operation.

First unscrew the Top Connector from the Bottom Connector by locking the Bottom Connector with a suitable spanner against a solid base and split the Top Connector at the spanner flats. Remove and inspect the Buffer. If this is showing any signs of wear or fatigue, it must be replaced. Now unscrew the Splined Nut from the Bottom Connector and remove the Shaft. Inspect the 'O' Ring and replace if necessary.

Note: Should the shockabsorber be difficult to break open, then cut out the Breakout Washer (item no.5) with a pencil grinder or similar. This should facilitate easier opening of the shockabsorber.

Important

It is inevitable that there will be progressive wear between the Bottom Connector shaft and the Nut. When this wear pattern exceeds 2mm in either component, it is recommended that this component be replaced since excessive wear will eventually lead to failure of the Bottom Connector shaft or thread with consequent loss of hammer and bit. Clean all the components and then coat the splines on both the Shaft and the Nut with good quality grease. Now, lower the Nut and shaft into the Bottom connector and tighten the Nut down. Then put the Thrust Washer over the Shaft so it sits on the Nut face, slide the Buffer down the Shaft up to the Washer face. Grease the internal top connector thread and screw down onto the Shaft. Using suitable spanners, torque up fully.

Size	HDSA12 6 5/8" API	HDSA12 8 5/8" API	HDSA14 8 5/8" API
Effective Length	724 mm / 28.5"	724 mm / 28.5"	727 mm / 28.6"
Outside Diameter	254 mm / 10.0"	254 mm / 10.0"	311 mm / 12.2"
Net Weight	229 Kg / 504 lbs	221 Kg / 486 lbs	230 Kg / 506 lbs

Components		HDSA12 6 5/8" API	HDSA12 8 5/8" API	HDSA14 8 5/8" API
1	Top Connector	SA12ST0880M	SA12ST0882M	SA14ST0880M
2	Buffer	SA12ST05	SA12ST05	SA12ST05
3	Thrust Washer	SA12ST04	SA12ST04	SA12ST04
4	Nut	SA12ST01	SA12ST01	SA14ST01
5	Breakout Washer	SA12ST25	SA12ST25	SA14ST25
6	Shaft	SA12ST02	SA12ST02	SA12ST02
7	Shaft 'O' Ring	SA12ST03	SA12ST03	SA12ST03
8	Bottom Connector	SA12ST0980F	SA12ST0982F	SA14ST0980F
	Complete	SA12ST080MF	SA12ST082MF	SA14ST080MF